



1 bed studio flat to buy in PO3

Honeywood Close, Hilsea, Portsmouth,
Hampshire, PO3 5BW

£60,000 Starting Bid

 x1  x1  x1

Tenure

Leasehold

Allocated parking

Property features

- ✓ Being sold via Secure Sale online bidding. Terms & Conditions apply
- ✓ Studio
- ✓ Secure Building
- ✓ Allocated Parking
- ✓ EPC Rating C

Key Information

- ✓ Council Tax: Band A
- ✓ EPC Rating: C
- ✓ Heating supply: Electric

Description

The property is nestled in a quiet cul-de-sac location and benefits from allocated parking, open plan living space, fitted kitchen and bathroom. Arrange a viewing today to avoid missing out.

INTERNALLY

The property is access through the secure buzzer system which takes you into the communal area. The property is situated on the second floor and comprises of an open plan living space, fitted kitchen with wall and base units, worksurfaces, stainless steel sink/drainer, electric hob and oven, space for a fridge/freezer and plumbing for a washing machine. The shower room has a shower cubical, wash hand basin and WC.

LOCATION

The property is situated in a quiet cul-de-sac location within close proximity to local amenities and transport links.

LIVING SPACE

KITCHEN

BATHROOM

AGENTS NOTES

Council Tax Band: A

Tenure: Leasehold

Length of Lease: 79

Annual Ground Rent Amount: £90.00

Annual Service Charge Amount: £30.00

Price: Starting Bid £60,000

Property Type: Studio flat

Parking: Allocated

Heating: Electric

GROUND FLOOR
249 sq.ft. (23.1 sq.m.) approx.

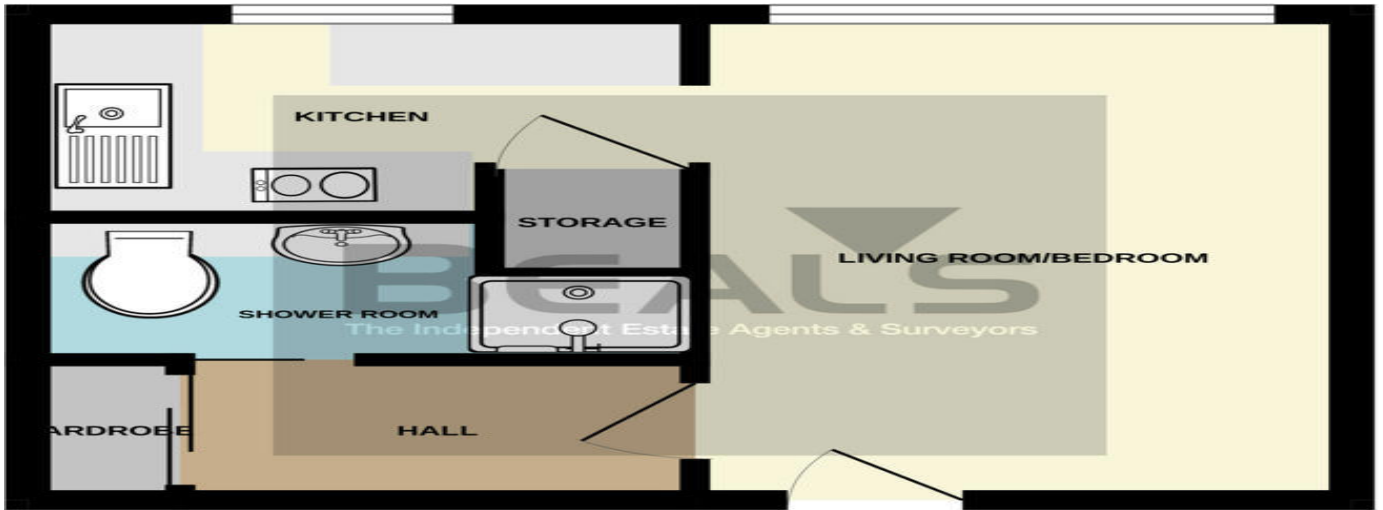

TOTAL FLOOR AREA - 249 sq.ft. (23.1 sq.m.) approx.
Whilst every attempt has been made to ensure the accuracy of the floorplan contained here, measurements of doors, windows, rooms and any other items are approximate and no responsibility is taken for any error, omission or mis-statement. This plan is for illustrative purposes only and should be used as such by any prospective purchaser. The services, systems and appliances shown have not been tested and no guarantee as to their operability or efficiency can be given.
Made with Metropix ©2024

Energy Efficiency Rating		Current	Potential
Very energy efficient - lower running costs			
(92-100) A			
(81-91) B			
(69-80) C			80
(55-68) D		69	
(39-54) E			
(21-38) F			
(1-20) G			
Not energy efficient - higher running costs			
England, Scotland & Wales		EU Directive 2002/91/EC	

Honeywood Close, Hilsea, Portsmouth, Hampshire, PO3 5BW

Contact your local branch today for more information on this property:

1 Chapel Lane, Pinner, Middlesex, HA5 1AA, Tel: 0208 866 0000, <http://www.gibbs-gillespie.co.uk>

These particulars, whilst believed to be accurate are set out as a general outline only for guidance and do not constitute any part of an offer or contract. Intending purchasers should not rely on them as statements of representation of fact, but must satisfy themselves by inspection or otherwise as to their accuracy. No person in this firms employment has the authority to make or give any representation or warranty in respect of the property.

