



3 bed terraced house to buy in

Joan Ward Street, Coventry, West Midlands, CV3 5FW

£180,000 Starting Bid

🏠 x3 🚗 x1 🚲 x2

Tenure

Freehold

Driveway parking

Property features

- ✓ Being Sold via Secure Sale online bidding. Terms and Conditions
- ✓ EPC Rating D

Key Information

- ✓ Council Tax: Band C
- ✓ EPC Rating: D
- ✓ Heating supply: Gas
- ✓ Electric supply: National Grid
- ✓ Water supply: Direct mains water
- ✓ Broadband: None
- ✓ Mobile signal: Good

Description

Nestled in the heart of Coventry on Joan Ward Street, this charming mid-terrace house presents an excellent opportunity for families and professionals alike. With three well-proportioned bedrooms, this property offers ample space for comfortable living. The two inviting reception rooms provide versatile areas that can be tailored to your needs, whether for entertaining guests or enjoying quiet evenings at home.

The current dining room offers excellent flexibility and could easily be utilised as a fourth bedroom, ideal for a larger family.

The house features a conveniently located bathroom, ensuring that daily routines are both practical and efficient. The layout of the property is designed to maximise space and light, creating a warm and welcoming atmosphere throughout.

Situated in a vibrant community, this home is close to local amenities, schools, and parks, making it an ideal choice for those seeking a balance of convenience and comfort. The surrounding area boasts excellent transport links, allowing for easy access to the wider Coventry region and beyond.

This property is perfect for anyone looking to establish roots in a lively neighbourhood while enjoying the benefits of a well-maintained home. With its appealing features and prime location, this mid-terrace house on Joan Ward Street is a must-see for prospective buyers or renters.

Council Tax Band: C

Tenure: Freehold

Price: Starting Bid £180,000

Property Type: Terraced House

Parking: Driveway

Year built: 1934

Construction materials: Brick and block

Roofing type: Clay tiles

Risk of floods and or erosion: No

Flooded in last 5 years: No

Flood defences: No

Planning permissions or proposals for development: No

Coalfield or mining area: No

Listed property: No

Conservation area: No

Public rights of way: No

Adaptions for accessibility: No

Restrictions: No

Required access: No

Heating: Gas

Electric: National Grid

Water: Direct mains water

Water meter: No

Sewerage: Standard UK domestic

Air conditioning: No

Broadband: None

Mobile signal coverage: Good

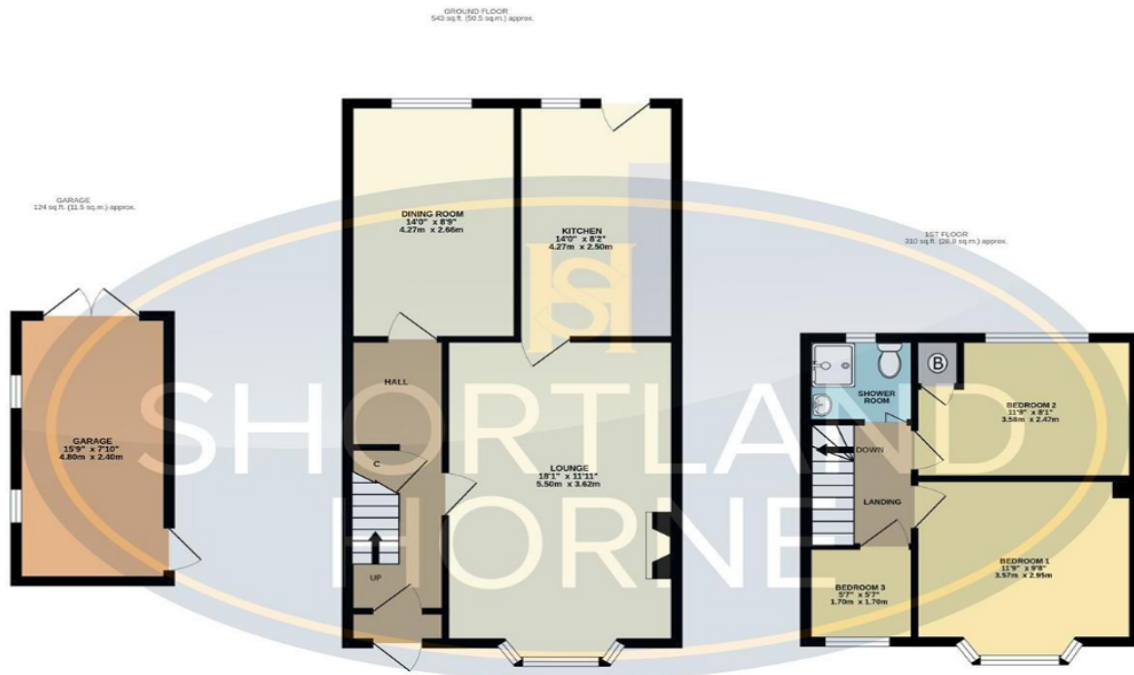

TOTAL FLOOR AREA : 978 sq.ft. (90.8 sq.m.) approx.

Whilst every attempt has been made to ensure the accuracy of the floorplan contained here, measurements of doors, windows, rooms and any other items are approximate and no responsibility is taken for any error, omission or mis-statement. This plan is for illustrative purposes only and should be used as such by any prospective purchaser. The services, systems and appliances shown have not been tested and no guarantee as to their operability or efficiency can be given.
Made with Metropix 62026

Energy Efficiency Rating		Current	Potential
Very energy efficient - lower running costs			
(92-100) A			
(81-91) B			
(69-80) C			77
(55-68) D	66		
(39-54) E			
(21-38) F			
(1-20) G			
Not energy efficient - higher running costs			
England, Scotland & Wales		EU Directive 2002/91/EC	

Joan Ward Street, Coventry, West Midlands, CV3 5FW

Contact your local branch today for more information on this property:

1 Chapel Lane, Pinner, Middlesex, HA5 1AA, Tel: 0208 866 0000, <http://www.gibbs-gillespie.co.uk>

These particulars, whilst believed to be accurate are set out as a general outline only for guidance and do not constitute any part of an offer or contract. Intending purchasers should not rely on them as statements of representation of fact, but must satisfy themselves by inspection or otherwise as to their accuracy. No person in this firm's employment has the authority to make or give any representation or warranty in respect of the property.

