



2 bed terraced house to buy in
Mills Terrace, Chatham, Kent, ME4 5NY

£115,000 Starting Bid

 x2  x1  x1

Tenure
Freehold

Garage parking

Property features

- ✓ Garage & Driveway
- ✓ Huge Front Garden
- ✓ Plenty Of Character
- ✓ A Short Walk to Chatham Station
- ✓ EPC Rating E

Key Information

- ✓ Council Tax: Band B
- ✓ EPC Rating: E
- ✓ Heating supply: Gas
- ✓ Electric supply: National Grid
- ✓ Water supply: Direct mains water
- ✓ Mobile signal: Good

Description

Being Sold via Secure Sale online bidding. Terms & Conditions apply.

*garage & driveway** **huge front garden** **chain free**

Do not miss this beautifully presented two-bedroom home, located in a quiet residential road in Chatham and offered with no onward chain!

This charming property has just been redecorated throughout, offering a fresh and inviting feel from the moment you step inside. It boasts a spacious driveway and a detached garage, providing ample off-road parking—an increasingly rare feature in the area.

Outside, you'll find a generous front garden—perfect for keen gardeners or those seeking extra outdoor space—and a low-maintenance courtyard-style garden to the rear, ideal for relaxed summer evenings with minimal upkeep.

With two well-proportioned bedrooms, a bright and airy living space, and move-in ready condition, this property would make an ideal first-time purchase or buy-to-let investment.

Freehold. Council Tax Band B. EPC Rating 47E.

Features• Double Bedrooms

• Fireplace

Parking Availability: Yes.

Council Tax Band: B

Tenure: Freehold

Price: Starting Bid £115,000

Property Type: Terraced House

Parking: Garage, Off Street

Year built: 1900

Construction materials: Brick and block

Roofing type: Slate tiles

Risk of floods and or erosion: No

Flooded in last 5 years: No

Flood defences: No

Planning permissions or proposals for development: No

Coalfield or mining area: No

Listed property: No

Conservation area: No

Public rights of way: No

Adaptions for accessibility: No

Restrictions: No

Required access: No

Heating: Gas

Electric: National Grid

Water: Direct mains water

Water meter: Yes

Sewerage: Standard UK domestic

Air conditioning: No

Mobile signal coverage: Good

BASEMENT
149 sq.ft. (13.9 sq.m.) approx.

GROUND FLOOR
412 sq.ft. (38.3 sq.m.) approx.

1ST FLOOR
287 sq.ft. (26.6 sq.m.) approx.

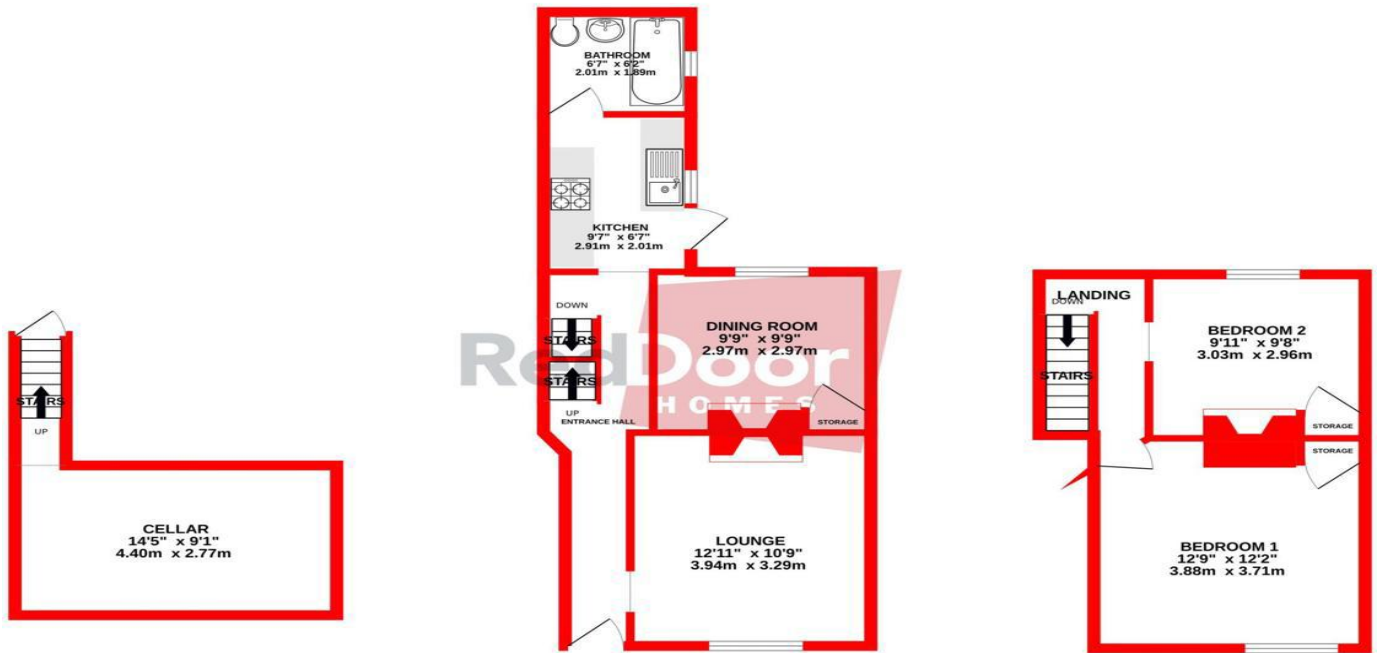

TOTAL FLOOR AREA : 848 sq.ft. (78.8 sq.m.) approx.

Whilst every attempt has been made to ensure the accuracy of the floorplan contained here, measurements of doors, windows, rooms and any other items are approximate and no responsibility is taken for any error, omission or mis-statement. This plan is for illustrative purposes only and should be used as such by any prospective purchaser. The services, systems and appliances shown have not been tested and no guarantee as to their operability or efficiency can be given.
Made with Metropix ©2024



Energy Efficiency Rating		
	Current	Potential
<i>Very energy efficient - lower running costs</i>		
(92-100) A		
(81-91) B		
(69-80) C		
(55-68) D		66
(39-54) E	50	
(21-38) F		
(1-20) G		
<i>Not energy efficient - higher running costs</i>		
England, Scotland & Wales	EU Directive 2002/91/EC	

Mills Terrace, Chatham, Kent, ME4 5NY

Contact your local branch today for more information on this property:

1 Chapel Lane, Pinner, Middlesex, HA5 1AA, Tel: 0208 866 0000, <http://www.gibbs-gillespie.co.uk>

These particulars, whilst believed to be accurate are set out as a general outline only for guidance and do not constitute any part of an offer or contract. Intending purchasers should not rely on them as statements of representation of fact, but must satisfy themselves by inspection or otherwise as to their accuracy. No person in this firm's employment has the authority to make or give any representation or warranty in respect of the property.



<http://www.gibbs-gillespie.co.uk> - 0208 866 0000